

有害物质管理标准

- 欧盟RoHS环保指令
- 欧盟RoHS环保指令+无卤素要求
- 有害物质管理标准 第 1 版

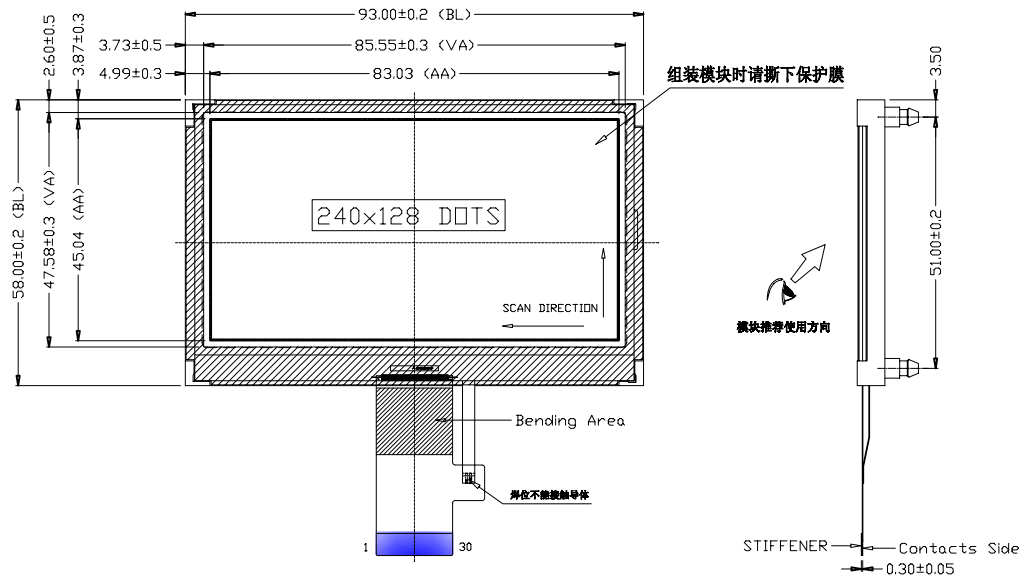

组装模块时请撕下保护膜

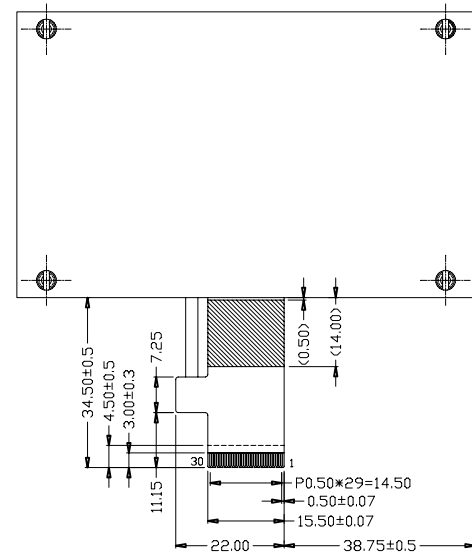

FPC DESCRIPTION

PIN	SYMBOL
1	LED_K
2	LED_A
3	VSS
4	VB0+
5	VB1+
6	VB1-
7	VB0-
8	VA0+
9	VA1+
10	VA1-
11	VA0-
12	VLCD
13	VDD
14	VSS
15	VR1
16	VR0
17	CD
18	CS0
19	RST
20	D0
21	D1
22	D2
23	D3
24	D4
25	D5
26	D6
27	D7
28	VSS
29	NC
30	NC

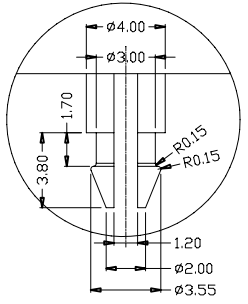
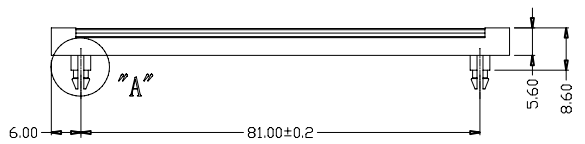

DETAIL A*
(SCALE 4:1)

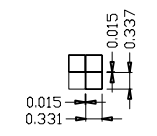

DOTS DETAIL
(SCALE 10:1)

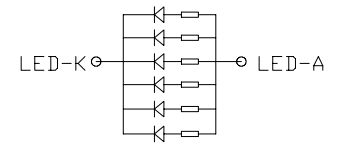

WHITE LED, Vf=3.3V, If=90mA(TYP)
BACKLIGHT CIRCUIT

NOTES:

1. OPERATING TEMP.: -25°C ~ +70°C
2. STORAGE TEMP.: -40°C ~ +70°C
3. IC DRIVER: UC1638
4. DUTY=1/128, BIAS=1/12, VLCD=15.5V, VDD=3.3V
5. LCD MODE: STN, BLUE, TRANSMISSIVE, NEGATIVE.
6. FLAT CONNECTOR 30 PINS
7. FIXING: BY PLASTIC SNAP-IN

CUSTOMER APVL	CUSTOMER	DATE	TITLE
DRAWN	TOLERANCE: X ±0.5 .XX ±0.3 ANGULAR: ±1/4°		MI240128I-G-2
DFTG CHK	UNIT mm		MODEL
ENGR CHK			
APPROVAL			
MULTI-INNO TECHNOLOGY CO.,LTD.			DWG NO
			PAGE 1/1